



Cadence®



**LAPAROSCOPIC
SUCTION / IRRIGATION DEVICE**

INTENDED USE

The Cadence® Suction/Irrigation device is a single use irrigation and aspiration system designed to deliver irrigation fluid into a body cavity and aspirate the fluid and debris during a surgical procedure.

WARNINGS

- This device is for single patient use only and can not be reused or re-sterilised.
- Do not use if package is opened or damaged.
- A complete understanding of techniques and principles involved in electrosurgical procedures is necessary to avoid burn or shock hazard to patient and/or operator.
- Endoscopic procedures must be performed only by surgeons with adequate training and knowledge of these procedures. In addition, medical literature should be consulted regarding techniques, hazards, contraindications and complications prior to the performance of these procedures.
- Do not operate device without both the shaft cap and secondary cap screwed in securely.
- Do not connect to irrigation bags unless the button clip has been removed.
- Not designed for use with powered irrigation fluid supply systems.

CONTRAINDICATIONS

This device is not intended for use when endoscopic techniques are contraindicated.

ACCESSORIES

The Cadence® Ø10mm suction irrigation shaft is designed for use with this handpiece.

USER INSTRUCTIONS

1. The non-sterile nurse peels open the packaging using appropriate aseptic technique and presents the device inside to the sterile instrument nurse.
2. The sterile instrument nurse removes the device and tubing using aseptic technique. The non-sterile nurse can dispose of the packaging.
3. The sterile instrument nurse tears the plastic sleeve surrounding the tubing along the tear line and removes the button clip around the handpiece and discards them.
4. The sterile instrument nurse closes the clamps on the tubing and removes the protective covers from the spikes at the end of the tubing.
5. Using aseptic technique, the spiked ends of the tubing are handed to the non-sterile nurse for insertion into irrigation fluid bag.
6. The non-sterile nurse inserts the spikes into irrigation fluid bag, opens the clamps on the tubing to allow the flow of fluid and attaches the blue suction connector to the suction canister.
7. The sterile instrument nurse depresses the irrigation button to check the flow of irrigation and depresses the suction button to ensure correct operation, prior to use.

ADDITIONAL NOTES

It is recommended the sterile instrument nurse prime and test the device prior to surgeon use. A pressure device may be applied to the irrigation bag when increased flow is required. If shaft is supplied unconnected, the sterile instrument nurse should attach it to the handpiece in the surgeons' preferred configuration, prior to use.

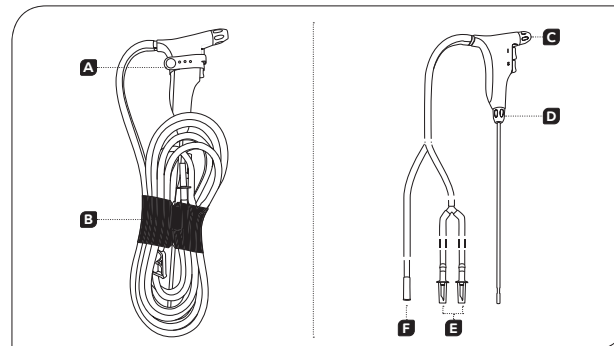

- A - Button clip, remove before use.
B - Plastic sleeve, remove before use.

- C - Secondary cap.
D - Shaft cap.
E - Spikes for irrigation fluid.
F - Suction connector.

GRIP CUSTOMISATION

The Cadence® Suction/Irrigation device can be used in either trumpet or pistol grip. To swap the grip, unscrew both the shaft cap and the secondary cap, swap positions and reattach both caps securely. Tighten in a clockwise direction.

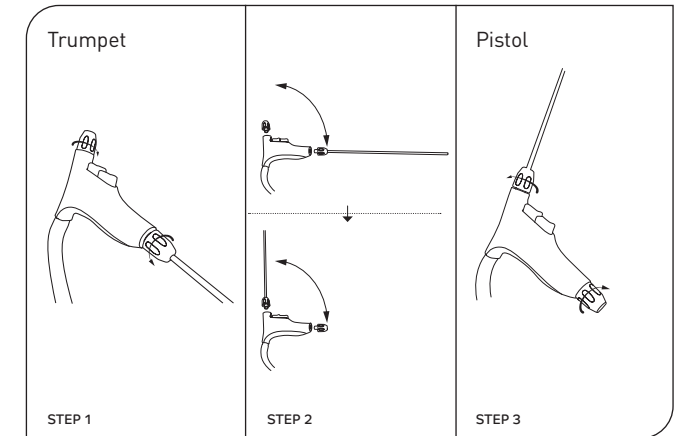

Received for outstanding design and innovation. Find out more:
Multigate.com.au/GDA



Multigate Medical Products
27 Llewellyn Avenue Villawood
NSW 2163 Australia
T +61 (0)2 8718 2888
F +61 (0)2 8718 2889
E enquiries@multigate.com.au
www.multigate.com.au

Multigate Co., Ltd.
7 Lanjiang Rd. 312000
Shaoxing China **CE 0123**
EC REP RFX+Care International A/S
Bakkegaardsvej
408 3050 Humlebaek
Denmark